

**PART CODE** \_\_\_\_\_

*For shower warranty*

# Quick Response™ Decon Shower

HM3000

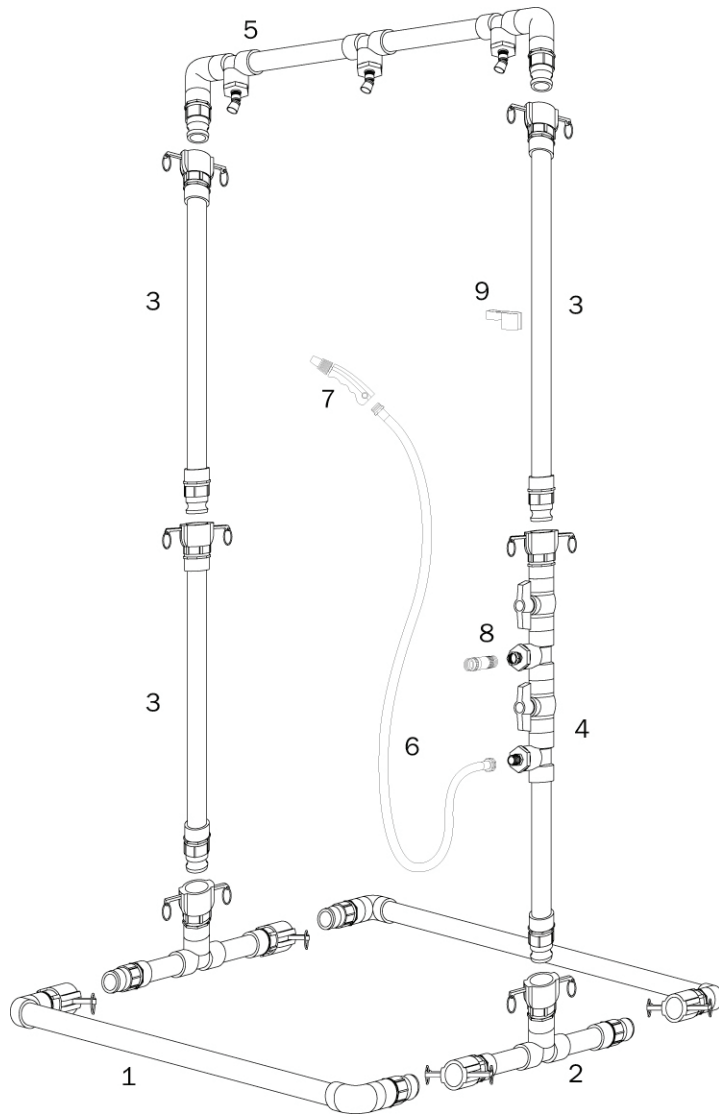

## Shower Assembly

- A. Remove, inspect, and count all parts (see Parts List below).
- B. Assemble base by connecting the two U-Bases (#1) to the Upright Couplings (#2).
- C. Insert Vertical Uprights (#3) and Valve Upright (#4) into Upright Couplings (#2) as shown.
- D. Top (#5) can then be connected. Position shower heads as desired.
- E. Connect Shower Hose (#6) with Handheld Spray Nozzle (#7) to bottom outlet of valve assembly. Screw in Pressure Reducing Valve (#8) to top outlet of valve assembly.
- F. Attach the Handheld Hose Hanger (#9) onto Vertical Upright above the valve assembly. Press firmly until hanger clamps around the pipe.

## Parts List

*Replacement parts are available and contact DQE to order.*

| PART NAME                          | QTY | PART NUMBER |
|------------------------------------|-----|-------------|
| 1. Bottom U-Base                   | 2   | HMPT30004   |
| 2. Upright Coupling                | 2   | HMPT30005   |
| 3. Vertical Upright                | 3   | HMPT30002   |
| 4. Valve Upright                   | 1   | HMPT30003   |
| 5. Top                             | 1   | HMPT30001   |
| 6. Shower Hose                     | 1   | HOSEBLUE    |
| 7. Handheld Spray Nozzle           | 1   | 2416-20     |
| 8. Pressure Reducing Valve         | 1   | G-9227      |
| 9. Handheld Hose Hanger            | 1   | HMPT10017   |
| 10. Vinyl Carry Bag<br>(not shown) | 1   | BAGQR       |

## Storage

- A. After use, the shower should be fully decontaminated using your standard operating procedures and in full compliance with state and federal regulations.
- B. The shower should be inspected for damage or missing parts and should be completely dry before storage.
- C. Store in vinyl carry bag in moderate environmental conditions out of direct sunlight or exposure to ozone.

**Caution:** *Regulate water temperature to avoid scalding.*